

**12-ports Antenna 1710-2170MHz 17dBi 0~10°T (Tri-sector)****HPBW: 65°****Connector: 4.3-10 Female****Electrical Specifications(BASTA)**

Frequency Range(MHz)	1710-2170		
	1710-1880	1850-1990	1920-2170
Polarization(°)	±45		
Electrical Downtilt(°)	0-10, continuously adjustable		
Gain (dBi)	16.0±0.5	16.2±0.5	16.5±0.5
First Upper Side Lobe Suppression (dB)	≥15		
Azimuth Beamwidth 3dB(°)	65±8	65±8	64±8
Elevation Beamwidth 3dB(°)	≥5.5	≥5	≥4.5
Cross-Polar Ratio @0°(dB)	≥15		
Front to Back Ratio 180°±30° ( dB)	≥23		
VSWR	≤1.5		
3rd PIM@2 x 43 dBm (dBc)	≤ -143		
Isolation (dB)	≥25		
Max. power per port(W)	200		
Impedance (Ω)	50		
Lightning Protection	DC Ground		

## Mechanical Specifications(BASTA)

RET type	Integrated RET (AISG2.0/3GPP)
AISG Connectors (1 input and 1 output)	2×8 pin (in: Male; out: Female)
Connector	3x4 x 4.3-10 Female , Bottom
Antenna dimensions (H x W x D) (mm)	Φ400x 1800
Antenna weight (kg)	81
Adjustable range of horizontal azimuth (°)	360(whole), 0(sector)
Radome material	UPVC
Radome color	white
Operational temperature (°C)	-40 ~ +60 °
Wind load @150km/h (N)	446/446/220(Frontal/Lateral/Rear side)
Max. operational wind speed (km/h)	359

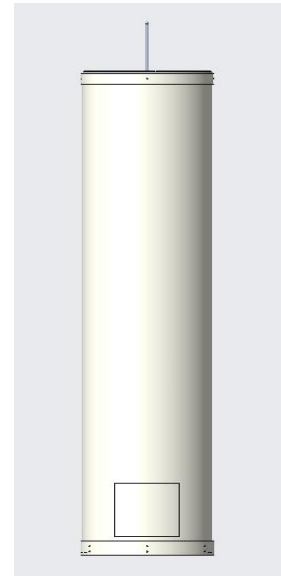

## Layout

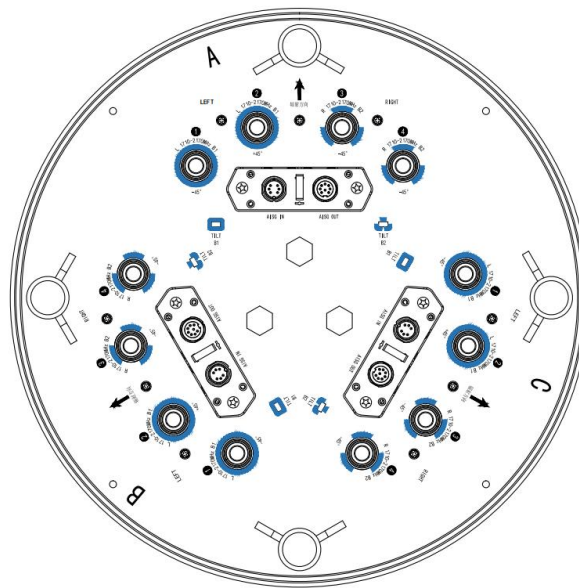

### Frequency Range

1710-2170MHz

### Array

B1/B2

### Connector

A/B/C

## Pattern

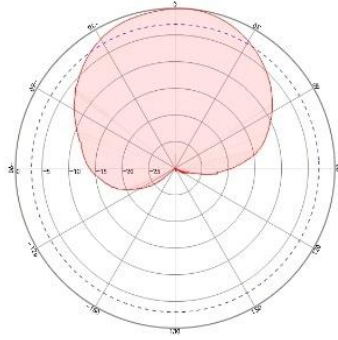

**1710-2170 Horizontal pattern**

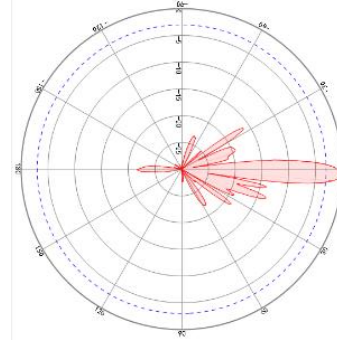

**1710-2170 Vertical pattern**

**Layout**

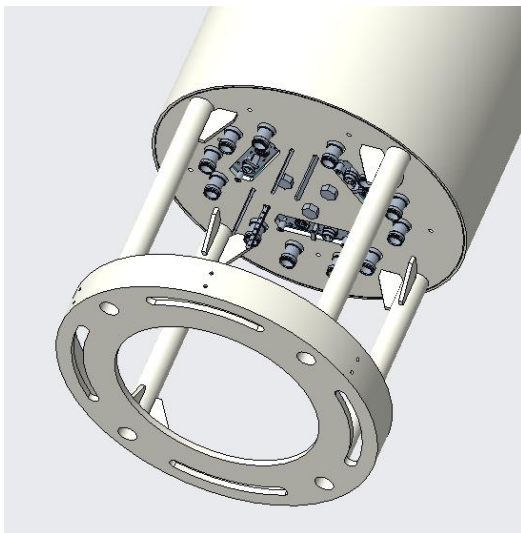

**Accessories**

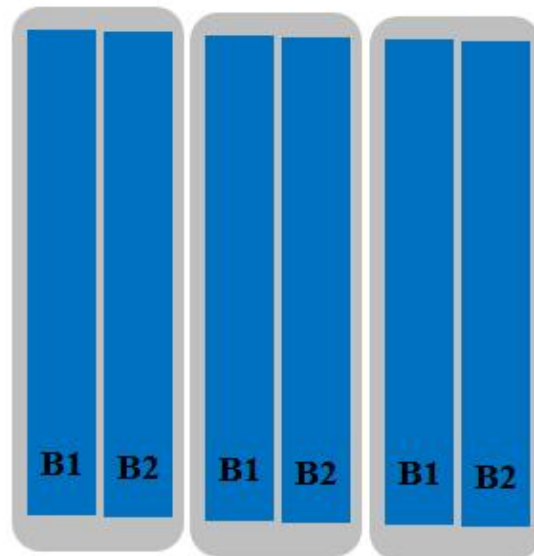

**Configuration Types**